

Energy Efficiency Rating		Current	Potential
Very energy efficient - lower running costs			
(92 plus)	A		
(81-91)	B		
(69-80)	C		
(55-68)	D		
(39-54)	E		
(21-38)	F		
(1-20)	G		
Not energy efficient - higher running costs			
England & Wales		EU Directive 2002/91/EC	

Disclaimer – In accordance with the Property Misdescriptions Act, the company gives notice that all descriptions, references to condition, necessary permissions for use and other details are given in good faith and believed to be correct, but any intending lessees do not rely on them as statements of fact, but must satisfy themselves by inspection or other means, as to their accuracy.

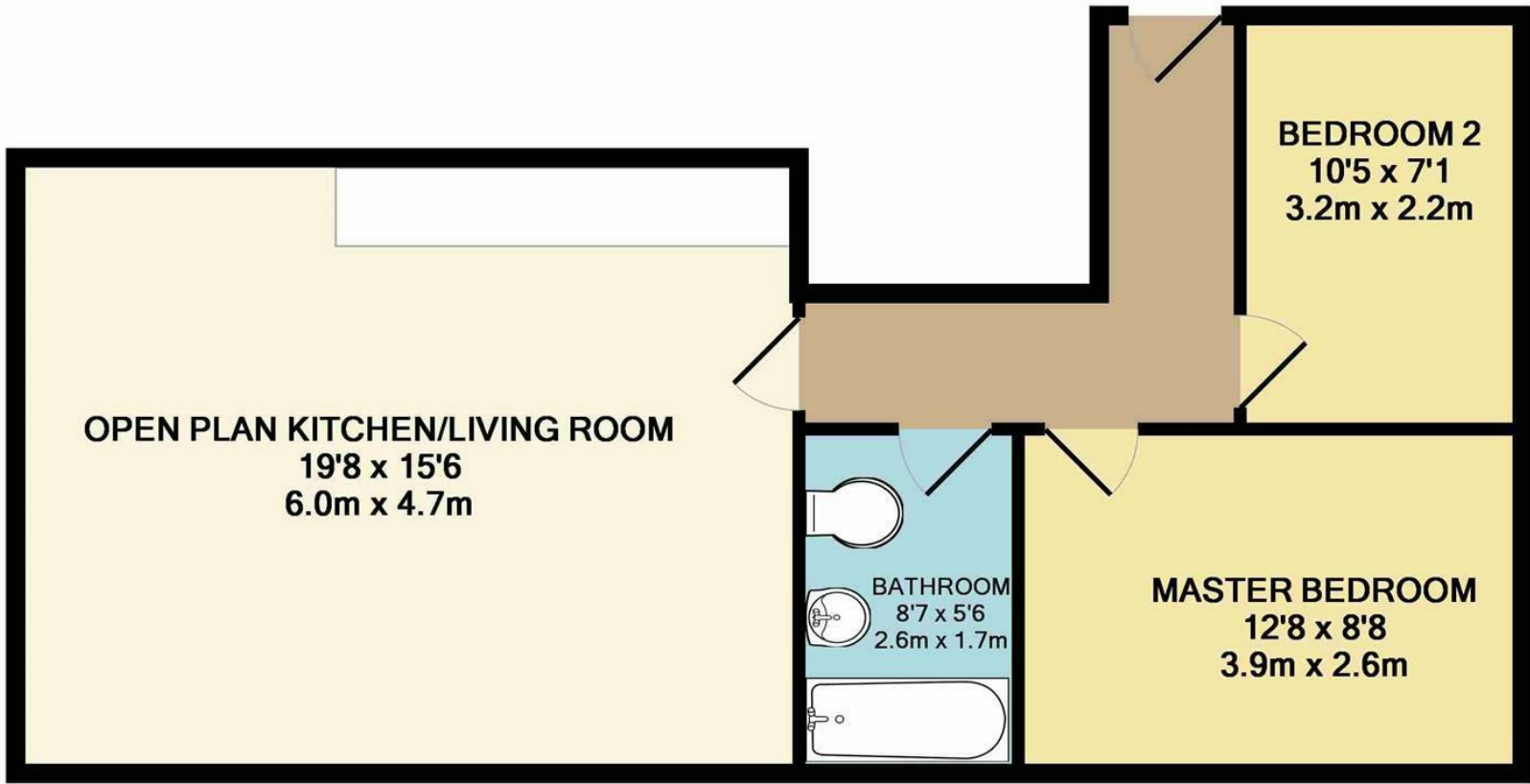

TOTAL APPROX. FLOOR AREA 599 SQ.FT. (55.6 SQ.M.)

Whilst every attempt has been made to ensure the accuracy of the floor plan contained here, measurements of doors, windows, rooms and any other items are approximate and no responsibility is taken for any error, omission, or mis-statement. This plan is for illustrative purposes only and should be used as such by any prospective purchaser. The services, systems and appliances shown have not been tested and no guarantee as to their operability or efficiency can be given  
 Made with Metropix ©2017



Skipper House | Norwich | NR1  
 Guide Price £180,000





abbotFox presents this two bedroom first-floor apartment located within a unique city-centre development. Offering an exceptional opportunity for any buyer looking to enjoy City living, this home offers two comfortable bedrooms, a stylish family bathroom and generous open plan living accommodation. An internal viewing comes highly recommended.

**Agents Note:**

The images shown are an example of the finish at this development and may not be specific to this apartment.

Guide Price £180,000-£190,000

